



 **PDT**  
products catalog

# DIAMOND TOOLS

for stone and construction

## CONTENTS

<b>1. General recommendations for use of diamond blades</b> .....	<b>4</b>
Signs and marking on the tool's label.....	6
Packaging of diamond tools .....	7
<b>2. Turbo diamond blades 1A1R for angle grinders</b> .....	<b>8</b>
1A1R Turbo Universal .....	9
1A1R Turbo Concrete.....	9
1A1R Turbo Granite.....	9
<b>3. Turbo diamond blades 1A1RSS for angle grinders</b> .....	<b>10</b>
1A1RSS Universal .....	11
1A1RSS Concrete .....	11
1A1RSS Granite.....	11
<b>4. Diamond blades 1A1R for angle grinders</b> .....	<b>12</b>
1A1R Ceramics.....	13
1A1R Ceramics Granite .....	13
1A1R Granite .....	14
1A1R Marble.....	14
1A1R Ceramics Slim .....	15
1A1R Relief Universal.....	15
<b>5. Diamond blades 1A1R for tile cutters and stationary equipment</b> .....	<b>16</b>
1A1R Ceramics Granite .....	17
1A1R Granite .....	17
1A1R Marble.....	17
<b>6. Diamond segmented blades 1A1RSS for gasoline and joint cutters</b> .....	<b>18</b>
1A1RSS Universal .....	19
1A1RSS Monolith Force.....	19
1A1RSS Monolith Hard .....	19
1A1RSS Monolith Speed.....	21
1A1RSS Monolith Hard MAX .....	21
<b>7. Diamond blades 1A1RSS for cutting asphalt</b> .....	<b>22</b>
1A1RSS Asphalt.....	23
1A1RSS Fresh Concrete .....	23
<b>8. Diamond segmented blades 1A1RSS for cutting natural stone on stationary equipment</b> .....	<b>24</b>
1A1RSS Granite.....	25
1A1RSS Firebrick/Sandstone .....	25
<b>9. Diamond segments for segmented blades</b> .....	<b>26</b>
Diamond segments for 1A1RSS Monolith Hard .....	27
Diamond segments for 1A1RSS Granite.....	27
Diamond segments for 1A1RSS Marble .....	27
<b>10. Segmented cup grinders</b> .....	<b>28</b>
Concrete segmented cup grinders .....	29
Concrete Plus segmented cup grinders .....	29
<b>11. Diamond segmented core</b> .....	<b>30</b>
Segmented core drills.....	31
<b>12. Diamond segments for core drills</b> .....	<b>32</b>
Type of diamond segments .....	33
Monolayer diamond segments .....	33
Diamond segments with bottom layer.....	33
<b>13. Diamond core drills for manual electric drills</b> .....	<b>34</b>
Rooftop diamond segments .....	34
<b>Core styles of diamond segmented blades</b> .....	<b>35</b>

### Our vision:

We are a modern manufacturing company, producing diamond and CBN tools.

As a well-established leader in this industry, we offer the widest range of products in Eastern Europe.

### Our mission:

To be an asset to our clients by supplying them with the highest quality professional diamond and CBN tools that maximize benefits due to innovative production technology and impeccable service provided by our professional team.





1. Properly selected tools significantly reduces cost of work. It is necessary to proceed from all costs of carrying out work by the tool, but not from the price of tool.
2. In case of productivity loss, it is necessary to dress the diamond layer (make sharpening of the blade). Briefly work around for any abrasive material - abrasive wheel, silicate brick, and asphalt. Dress or sharpen the blade with a soft asphalt block, abrasive wheel or silicate brick to expose new diamonds.
3. Despite the fact that the diamond is the hardest material in nature, nevertheless, it has an increased fragility. During diamond tool work shock loads are not allowed, which can occur when the tool is misused

**Speed conversion chart for blades with 300 - 600 mm diameter**

Blade diameter D, mm	Linear Speed, m/s						
	25	30	35	40	45	50	60
	Shaft rotation frequency, r.p.m.						
300	1600	1900	2200	2500	2860	3200	3800
350	1300	1600	1900	2200	2450	2700	3250
400	1200	1400	1650	1900	2140	2400	2850
450	1000	1250	1500	1700	1910	2100	2500
500	950	1150	1600	1500	1710	1900	2300
600	800	950	1100	1250	1430	1600	1900

To achieve maximum efficiency during the work on stationary equipment, the following recommendations should be followed:

Blade diameter D, mm	Drive power Nmin, kW	Water supply l / min	Maximum depth of cut, mm	Flange dimensions			
				min Ø F, mm	P, mm	S, mm	J, mm
300	2,2 - 5,5	10 - 15	110	80	15	15	2
350	2,2 - 5,5	10 - 15	115	120	15	15	2
400	2,2 - 5,5	10 - 15	130	140	15	15	2
450	3 - 7	15 - 20	155	140	15	15	2
500	5 - 9	15 - 20	170	160	20	16	2
600	7 - 12	20 - 30	210	180	20	16	2



## 2. Turbo diamond blades 1A1R for angle grinders



### 1A1R Turbo Universal



#### APPLICATION

- Cutting of concrete and light reinforced concrete, bricks, paving slabs;

- Manual equipment (angle grinder);
- No coolant required.

Catalog number	Shape	Diameter, mm	Layer thickness, mm	Layer height, mm	Arbor hole, mm
810200TUNVu	1A1R Turbo	125	2,2	8	22,23
810600TUNVu	1A1R Turbo	230	2,6	10	22,23

### 1A1R Turbo Concrete

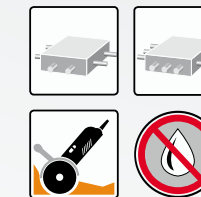

#### APPLICATION

- Cutting of reinforced and high-reinforced concrete;

- Manual equipment (angle grinder);
- No coolant required.

Catalog number	Shape	Diameter, mm	Layer thickness, mm	Layer height, mm	Arbor hole, mm
810200TCRTu	1A1R Turbo	125	2,2	8	22,23
810600TCRTu	1A1R Turbo	230	2,6	10	22,23

### 1A1R Turbo Granite



#### APPLICATION

- Cutting of granite, marble, sandstone;

- Manual equipment (angle grinder);
- No coolant required.

Catalog number	Shape	Diameter, mm	Layer thickness, mm	Layer height, mm	Arbor hole, mm
810200TGRu	1A1R Turbo	125	2,2	8	22,23
810600TGRu	1A1R Turbo	230	2,6	10	22,23

### 3. Turbo diamond blades 1A1RSS for angle grinders



#### 1A1RSS Universal



##### APPLICATION

- Cutting of concrete and light reinforced concrete, bricks, paving slabs;

- Manual equipment (angle grinder);
- No coolant required.

Catalog number	Shape	Diameter, mm	Layer thickness, mm	Layer height, mm	Arbor hole, mm
830200UNVu	1A1RSS/C3	125	2,2	8	22,23
830600UNVu	1A1RSS/C3	230	2,6	10	22,23

#### 1A1RSS Concrete



##### APPLICATION

- Cutting of reinforced and high-reinforced concrete;

- Manual equipment (angle grinder);
- No coolant required.

Catalog number	Shape	Diameter, mm	Layer thickness, mm	Layer height, mm	Arbor hole, mm
830200CRTu	1A1RSS/C3	125	2,2	8	22,23
830600CRTu	1A1RSS/C3	230	2,6	10	22,23

#### 1A1RSS Granite



##### APPLICATION

- Cutting of granite, marble, sandstone;

- Manual equipment (angle grinder);
- No coolant required.

Catalog number	Shape	Diameter, mm	Layer thickness, mm	Layer height, mm	Arbor hole, mm
830200GRu	1A1RSS/C3	125	2,2	8	22,23
830600GRu	1A1RSS/C3	230	2,6	10	22,23

## 4. Diamond blades 1A1R for angle grinders



### 1A1R Ceramics

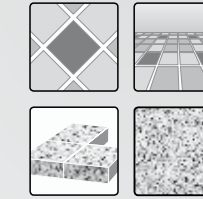

#### APPLICATION

- Cutting of wall and floor ceramic tiles;



- Manual equipment (angle grinder);
- No coolant required.

Catalog number	Shape	Diameter, mm	Layer thickness, mm	Layer height, mm	Arbor hole, mm
820200CRMu	1A1R	125	1,4	10	22,23
820601CRMu	1A1R	230	2,0	10	22,23

### 1A1R Ceramics Granite

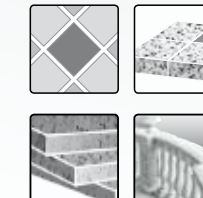

#### APPLICATION

- Cutting of wall and floor ceramic tiles, ceramic granite;



- Manual equipment (angle grinder);
- No coolant required.

Catalog number	Shape	Diameter, mm	Layer thickness, mm	Layer height, mm	Arbor hole, mm
820200CRMGu	1A1R	125	1,4	10	22,23
820601CRMGu	1A1R	230	2,0	10	22,23

## 1A1R Granite



- APPLICATION**
- Cutting of different types of granite;
  - Manual equipment (angle grinder);
  - No coolant required.

Catalog number	Shape	Diameter, mm	Layer thickness, mm	Layer height, mm	Arbor hole, mm
820200CGRu	1A1R	125	1,4	10	22,23
820601CGRu	1A1R	230	2,0	10	22,23

## 1A1R Marble



- APPLICATION**
- Cutting of all types of marble, sandstone;
  - Manual equipment (angle grinder);
  - No coolant required.

Catalog number	Shape	Diameter, mm	Layer thickness, mm	Layer height, mm	Arbor hole, mm
820200CMRu	1A1R	125	1,4	10	22,23
820601CMRu	1A1R	230	2,0	10	22,23

## 1A1R Ceramics Slim



- APPLICATION**
- Wall ceramic tiles, floor ceramic tiles, porcelain stoneware, marble, granite;
  - Manual equipment (angle grinder);
  - No coolant required.

Catalog number	Shape	Diameter, mm	Layer thickness, mm	Layer height, mm	Arbor hole, mm
820203CRMSu	1A1R	125	1,2	10	22,23

## 1A1R Relief Universal



- APPLICATION**
- Cutting of granite, marble, porcelain stoneware, paving tiles, ceramic tiles;
  - Manual equipment (angle grinder);
  - No coolant required.

Catalog number	Shape	Diameter, mm	Layer thickness, mm	Layer height, mm	Arbor hole, mm
820202RLFu	1A1R	125	1,2	10	22,23



## 5. Diamond blades 1A1R for tile cutters and stationary equipment



### 1A1R Ceramics Granite

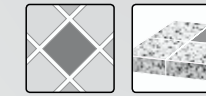

#### APPLICATION

- Cutting of ceramic tiles and ceramic granite;
- Tile cutters and other stationary equipment;
- Cooling is mandatory.

Catalog number	Shape	Diameter, mm	Layer thickness, mm	Layer height, mm	Arbor hole, mm
820401CRMG	1A1R	180	1,6	10	25,4
820501CRMG	1A1R	200	1,6	10	25,4
820602CRMG	1A1R	230	1,6	10	25,4
820701CRMG	1A1R	250	1,6	10	25,4
820804CRMG	1A1R	300	2,2	10	32
820904CRMG	1A1R	350	2,2	10	32
820905CRMG	1A1R	400	2,2	10	32

### 1A1R Granite

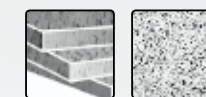

#### APPLICATION

- Cutting of different types of granite;



- Tile cutters and other stationary equipment;
- Cooling is mandatory.

Catalog number	Shape	Diameter, mm	Layer thickness, mm	Layer height, mm	Arbor hole, mm
820401CGR	1A1R	180	1,6	10	25,4
820501CGR	1A1R	200	1,6	10	25,4
820602CGR	1A1R	230	1,6	10	25,4
820701CGR	1A1R	250	1,6	10	25,4
820804CGR	1A1R	300	2,2	10	32
820904CGR	1A1R	350	2,2	10	32
820905CGR	1A1R	400	2,2	10	32

### 1A1R Marble



#### APPLICATION

- Cutting of different types of marble;



- Tile cutters and other stationary equipment;
- Cooling is mandatory.

Catalog number	Shape	Diameter, mm	Layer thickness, mm	Layer height, mm	Arbor hole, mm
820401CMR	1A1R	180	1,6	10	25,4
820501CMR	1A1R	200	1,6	10	25,4
820602CMR	1A1R	230	1,6	10	25,4
820701CMR	1A1R	250	1,6	10	25,4
820804CMR	1A1R	300	2,2	10	32
820904CMR	1A1R	350	2,2	10	32
820905CMR	1A1R	400	2,2	10	32

## 6. Diamond segmented blades 1A1RSS for gasoline and joint cutters

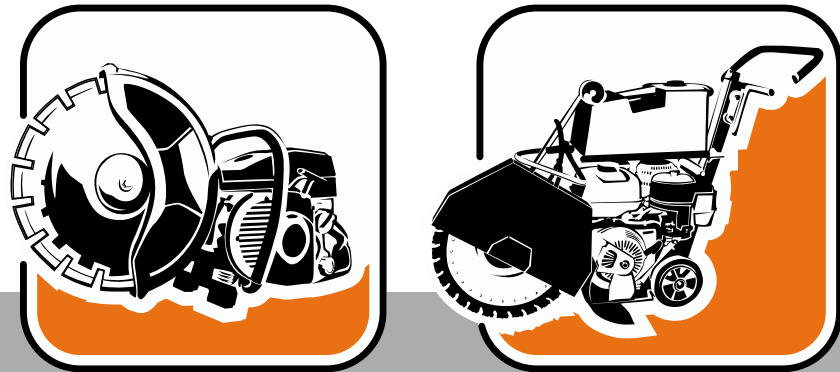

Segmented blades produced on DR. FRITSCH equipment by laser welding, brazing and sintering of segments onto the core.



### 1A1RSS Universal

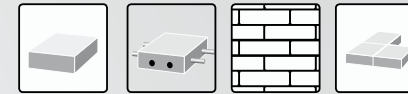

#### APPLICATION

- Cutting of concrete and light reinforced concrete, bricks, paving slabs;
- Gasoline and joint cutters;
- For blades with high frequency current soldering the use of coolant is mandatory. With laserwelded segments short-term cutting without coolant is permissible.

Catalog number	Shape	Diameter, mm	Thickness of layer, mm	Height of layer, mm	Arbore hole, mm	Number of segments, pcs.
71406BUNV	1A1RSS/C1	300	2,8	10	25,4	18
71407BUNV	1A1RSS/C1	350	3,2	10	25,4	21
71408BUNV	1A1RSS/C1	400	3,5	10	25,4	24
71409BUNV	1A1RSS/C1	450	3,8	10	25,4	27
71410BUNV	1A1RSS/C1	500	3,8	10	25,4	30
71411BUNV	1A1RSS/C1	600	4,5	10	25,4	36

### 1A1RSS Monolith Force

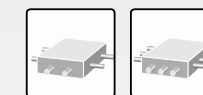

#### APPLICATION

- Cutting of reinforced and high-reinforced concrete;
- Gasoline and joint cutters;
- For blades with high frequency current soldering the use of coolant is mandatory. With laserwelded segments short-term cutting without coolant is permissible.

Catalog number	Shape	Diameter, mm	Thickness of layer, mm	Height of layer, mm	Arbore hole, mm	Number of segments, pcs.
71107BMFC	1A1RSS/C2	300	2,8	10	25,4	20
71108BMFC	1A1RSS/C2	350	3,2	10	25,4	24
71109BMFC	1A1RSS/C2	400	3,5	10	25,4	28

### 1A1RSS Monolith Hard

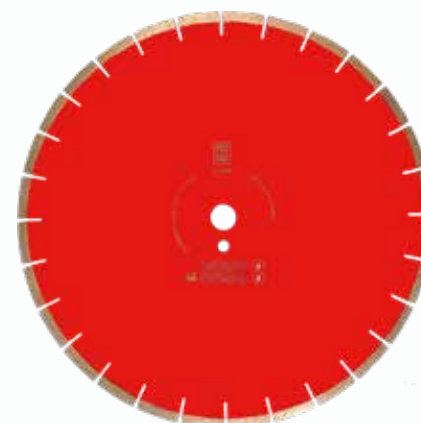
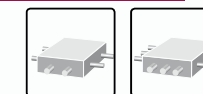

#### APPLICATION

- Cutting of reinforced and high-reinforced concrete;
- Gasoline cutters and other stationary;
- For blades with high frequency current soldering the use of coolant is mandatory. With laserwelded segments short-term cutting without coolant is permissible.

Catalog number	Shape	Diameter, mm	Thickness of layer, mm	Height of layer, mm	Arbore hole, mm	Number of segments, pcs.
71110BMHD	1A1RSS/C2	450	3,8	10	25,4	31
71111BMHD	1A1RSS/C2	500	3,8	10	25,4	35
71113BMHD	1A1RSS/C2	600	4,5	10	25,4	42
71208BMHD	1A1RSS/C2	810	6	10	60	57
71209BMHD	1A1RSS/C2	904	7	10	60	64
71200BMHD	1A1RSS/C1	810	6	10	60	46
71201BMHD	1A1RSS/C1	904	7	10	60	56

## 6. Diamond segmented blades 1A1RSS for gasoline and joint cutters

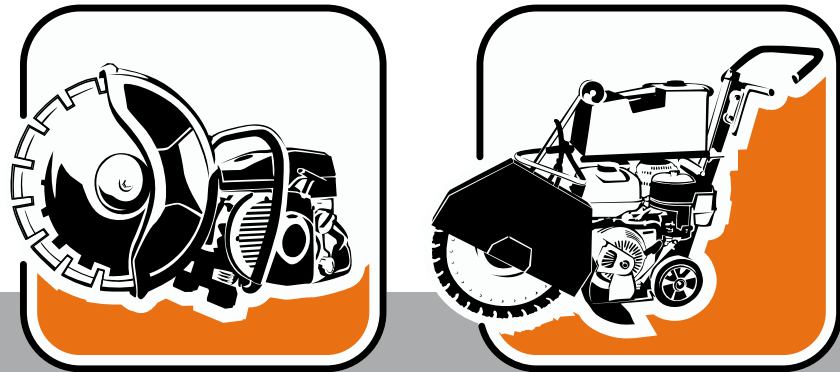

### 1A1RSS Monolith Speed

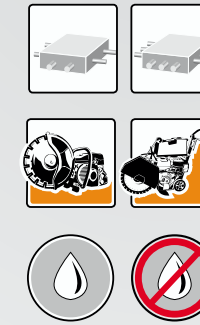

#### APPLICATION

- Cutting of high-reinforced concrete;
- Gasoline and joint cutters;
- For blades with high frequency current soldering the use of coolant is mandatory. With laserwelded segments short-term cutting without coolant is permissible.

Catalog number	Shape	Diameter, mm	Thickness of layer, mm	Height of layer, mm	Arbore hole, mm	Number of segments, pcs.
71107BMSD	1A1RSS/C2	300	2,8	10	25,4	20
71108BMSD	1A1RSS/C2	350	3,2	10	25,4	24
71109BMSD	1A1RSS/C2	400	3,5	10	25,4	28

### 1A1RSS Monolith Hard MAX

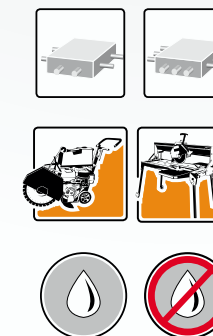
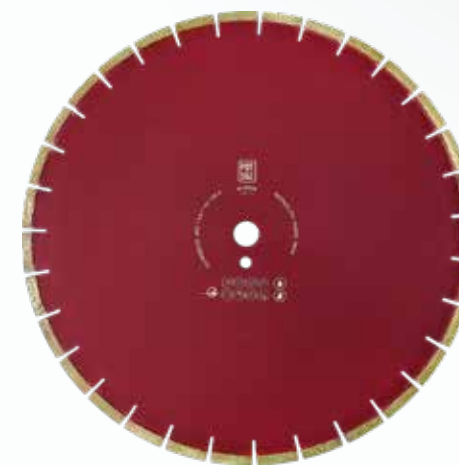

#### APPLICATION

- Cutting of high-reinforced concrete;
- Gasoline cutters and other stationary equipment;
- For blades with high frequency current soldering the use of coolant is mandatory. With laserwelded segments short-term cutting without coolant is permissible.

Catalog number	Shape	Diameter, mm	Thickness of layer, mm	Height of layer, mm	Arbore hole, mm	Number of segments, pcs.
71110BMHM	1A1RSS/C2	450	3,8	10	25,4	31
71111BMHM	1A1RSS/C2	500	3,8	10	25,4	35
71113BMHM	1A1RSS/C2	600	4,5	10	25,4	42
71208BMHM	1A1RSS/C2	810	6	10	60	57
71209BMHM	1A1RSS/C2	904	7	10	60	64
71200BMHM	1A1RSS/C1	810	6	10	60	46
71201BMHM	1A1RSS/C1	904	7	10	60	56

## 7. Diamond blades 1A1RSS for cutting asphalt



### 1A1RSS Asphalt

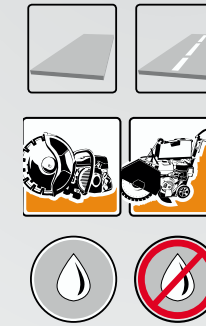

#### APPLICATION

- Cutting of fine-grained and coarse-grained asphalt, fresh concrete;

- Gasoline and joint cutters;

- For blades with high frequency current soldering the use of coolant is mandatory. With laserwelded segments short-term cutting without coolant is permissible.

Catalog number	Shape	Diameter, mm	Thickness of layer, mm	Height of layer, mm	Arbore hole, mm	Number of segments, pcs.
71300BASP	1A1RSS/C1	300	2,8	10	25,4	18
71301BASP	1A1RSS/C1	350	3,2	10	25,4	21
71302BASP	1A1RSS/C1	400	3,5	10	25,4	24
71303BASP	1A1RSS/C1	450	3,8	10	25,4	27
71304BASP	1A1RSS/C1	500	3,8	10	25,4	30
71305BASP	1A1RSS/C1	600	4,5	10	25,4	36

### 1A1RSS Fresh Concrete

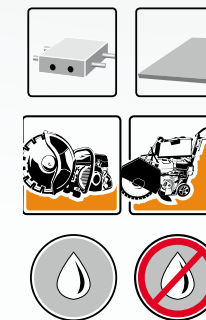

#### APPLICATION

- Cutting of fresh concrete;

- Gasoline and joint cutters of high and medium capacity;

- For blades with high frequency current soldering the use of coolant is mandatory. With laserwelded segments short-term cutting without coolant is permissible.

Catalog number	Shape	Diameter, mm	Thickness of layer, mm	Height of layer, mm	Arbore hole, mm	Number of segments, pcs.
71107BFC	1A1RSS/C2	300	2,8	10	25,4	20
71108BFC	1A1RSS/C2	350	3,2	10	25,4	24
71109BFC	1A1RSS/C2	400	3,5	10	25,4	28
71110BFC	1A1RSS/C2	450	3,8	10	25,4	31
71111BFC	1A1RSS/C2	500	3,8	10	25,4	35
71113BFC	1A1RSS/C2	600	4,5	10	25,4	42
71208BFC	1A1RSS/C2	810	6	10	60	57
71209BFC	1A1RSS/C2	904	7	10	60	64

## 8. Diamond segmented blades 1A1RSS for cutting natural stone on stationary equipment



### 1A1RSS Granite



#### APPLICATION

- Cutting of all types of granite, labradorite;



- Stationary equipment;



- Cooling is mandatory.

Catalog number	Shape	Diameter, mm	Thickness of layer, mm	Height of layer, mm	Arbore hole, mm	Number of segments, pcs.
61135CGR	1A1RSS/C2	300	2,8	10	60	20
61128CGR	1A1RSS/C2	310	2,8	15	60	20
61136CGR	1A1RSS/C2	350	3,2	10	60	24
61129CGR	1A1RSS/C2	360	3,2	15	60	24
61137CGR	1A1RSS/C2	400	3,5	10	60	28
61130CGR	1A1RSS/C2	410	3,5	15	60	28
61139CGR	1A1RSS/C2	500	3,8	10	60	35
61132CGR	1A1RSS/C2	510	3,8	15	60	35
61141CGR	1A1RSS/C2	600	4,5	10	60	42
61134CGR	1A1RSS/C2	610	4,5	15	60	42

### 1A1RSS Firebrick/Sandstone



#### APPLICATION

- Cutting of refractory materials, bricks, tiles and all types of sandstone;



- gasoline and joint cutters of medium capacity;



- For blades with high frequency current soldering the use of coolant is mandatory. With laserwelded segments short-term cutting without coolant is permissible.

Catalog number	Shape	Diameter, mm	Thickness of layer, mm	Height of layer, mm	Arbore hole, mm	Number of segments, pcs.
71406BFB	1A1RSS/C1	300	2,8	10	25,4	18
71407BFB	1A1RSS/C1	350	3,2	10	25,4	21
71408BFB	1A1RSS/C1	400	3,5	10	25,4	24
71409BFB	1A1RSS/C1	450	3,8	10	25,4	28
71410BFB	1A1RSS/C1	500	3,8	10	25,4	30
71411BFB	1A1RSS/C1	600	4,5	10	25,4	36
71107BFB	1A1RSS/C2	300	2,8	10	25,4	20
71108BFB	1A1RSS/C2	350	3,2	10	25,4	24
71109BFB	1A1RSS/C2	400	3,5	10	25,4	28
71110BFB	1A1RSS/C2	450	3,8	10	25,4	31
71111BFB	1A1RSS/C2	500	3,8	10	25,4	35
71113BFB	1A1RSS/C2	600	4,5	10	25,4	42

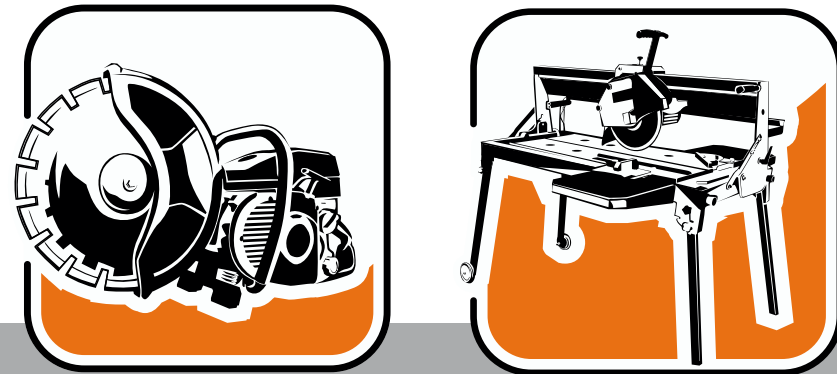

## Diamond segments for 1A1RSS Monolith Hard

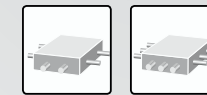

### APPLICATION

- Cutting of reinforced concrete;



- gasoline and joint cutters;
- cooling is mandatory.

Catalog number	Segment size	Blade diameter, mm
62110AMHD	40 x 4,1 x 10	500
62111AMHD	40 x 4,8 x 10	600
62200AMHD	40 x 6 x 10	810
62201AMHD	40 x 7 x 10	904

## Diamond segments for 1A1RSS Granite



### APPLICATION

- Cutting of all types of granite, labradorite;



- stationary equipment;
- cooling is mandatory.

Catalog number	Segment size	Blade diameter, mm
62100CGR	40 x 3,1 x 15	310
62101CGR	40 x 3,5 x 15	360
62102CGR	40 x 3,8 x 15	410
62104CGR	40 x 4,1 x 15	510
62105CGR	40 x 4,8 x 15	610
62202CGR	40 x 6 x 15	820
62600CGR	24 x 8 x 15	from 1000

## Diamond segments for 1A1RSS Marble



### APPLICATION

- Cutting of all types of marble;



- stationary equipment;
- cooling is mandatory.

Catalog number	Segment size	Blade diameter, mm
62300AMR	24 x 10 x 12	1000 - 1600





## Concrete segmented cup grinders

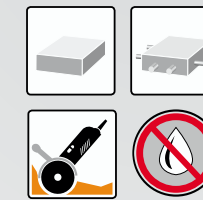

### APPLICATION

- Grinding of concrete;
- Manual equipment (angle grinder);
- No coolant required.

Catalog number	Diameter, mm	Number of segments, pcs.	Height of layer, mm	Arbor hole, mm
65002CRT	125	20	6	22,23
65151CRT	150	24	6	22,23
65181CRT	180	28	6	22,23
65231CRT	230	36	6	22,23

## Concrete Plus segmented cup grinders

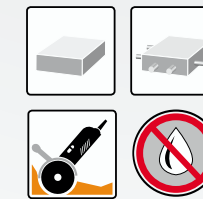

### APPLICATION

- Grinding of concrete. Increased cup grinder life;
- Manual equipment (angle grinder);
- No coolant required.

Catalog number	Diameter, mm	Number of segments, pcs.	Height of layer, mm	Arbor hole, mm
65001CRTP	125	20	8	22,23
65150CRTP	150	24	8	22,23
65180CRTP	180	28	8	22,23
65230CRTP	230	36	8	22,23





Segmented core drills produced on DR. FRITSCH equipment by laser welding and brazing of segments onto the core.



## Segmented core drills

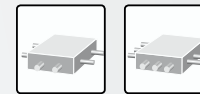

### APPLICATION

- Drilling of reinforced concrete;



- Drilling machines of medium capacity;
- Cooling is mandatory.



- For laser welded segments dry short term work is allowed

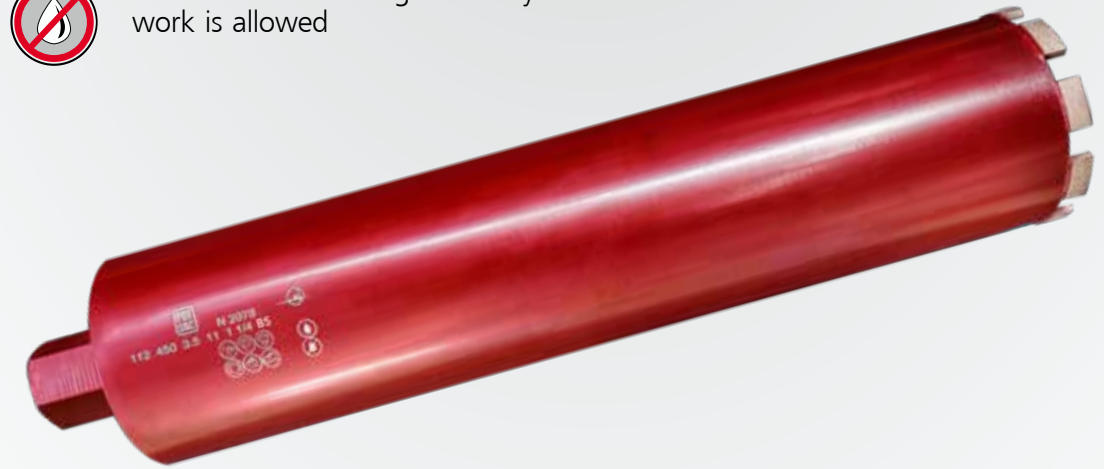

Types of core drill segments	APPLICATION
<b>BS</b>	Segmented core drill of high drilling speed for drilling highly-reinforced concrete.
<b>BH</b>	Segmented core drill of high drilling speed for drilling durable high-reinforced concrete. It has advanced lifetime.
<b>BSH</b>	Segmented core drill of high drilling speed for drilling durable high-reinforced concrete. It has greatest lifetime.

Catalog number	Core drill diameter, mm	Number of segments	Length of the Core drill, mm	Segment size	Mounting
63005ABS	62	6	450	24 x 3,5 x 11	1 1/4"
63006ABS	68	6	450	24 x 3,5 x 11	1 1/4"
63007ABS	72	6	450	24 x 3,5 x 11	1 1/4"
63008ABS	77	7	450	24 x 3,5 x 11	1 1/4"
63009ABS	82	7	450	24 x 3,5 x 11	1 1/4"
63010ABS	92	8	450	24 x 3,5 x 11	1 1/4"
63011ABS	102	9	450	24 x 3,5 x 11	1 1/4"
63012ABS	112	9	450	24 x 3,5 x 11	1 1/4"
63013ABS	122	10	450	24 x 3,5 x 11	1 1/4"
63014ABS	132	10	450	24 x 4 x 11	1 1/4"
63015ABS	142	12	450	24 x 4 x 11	1 1/4"
63016ABS	152	12	450	24 x 4 x 11	1 1/4"
63017ABS	162	12	450	24 x 4 x 11	1 1/4"
63018ABS	172	13	450	24 x 4 x 11	1 1/4"
63019ABS	182	13	450	24 x 4 x 11	1 1/4"
63020ABS	200	14	450	24 x 4,5 x 11	1 1/4"





## Type of diamond segments

Type of segments	APPLICATION
BS	Segment of high drilling speed for drilling highly-reinforced concrete.
BH	Segment of high drilling speed for drilling durable high-reinforced concrete. It has advanced lifetime.
BSH	Segment of high drilling speed for drilling durable high-reinforced concrete. It has greatest lifetime.

## Monolayer diamond segments

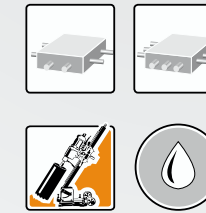
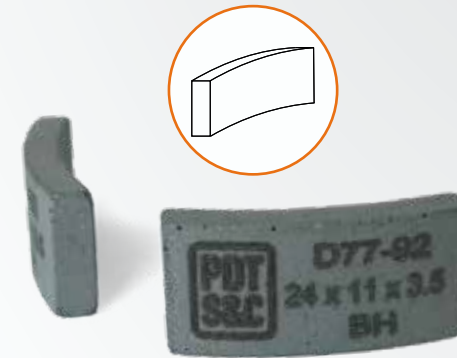

### APPLICATION

- Drilling of reinforced concrete;
- Drilling machines with medium capacity.

Catalog number	Segment size	Core drill diameter, mm
64003ABH (BS; BSH)	24 x 3,5 x 11	D62 – 72
64004ABH (BS; BSH)	24 x 3,5 x 11	D77 – 92
64005ABH (BS; BSH)	24 x 3,5 x 11	D102 – 127
64006ABH (BS; BSH)	24 x 4 x 11	D132 – 152
64007ABH (BS; BSH)	24 x 4 x 11	D162 – 182
64008ABH (BS; BSH)	24 x 4,5 x 11	D200 – 275
64009ABH (BS; BSH)	20 x 5 x 11	D300 – 600

## Diamond segments with bottom layer

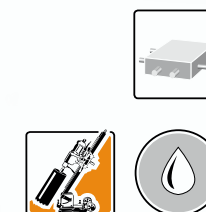
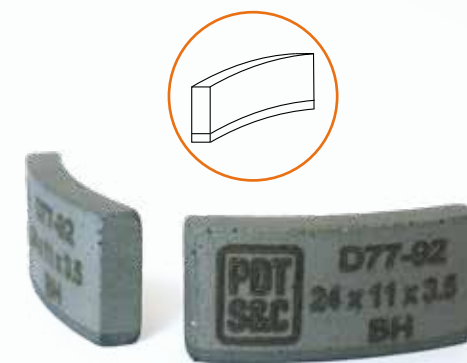

### APPLICATION

- Drilling of reinforced concrete;
- drilling machines with medium capacity.

Catalog number	Segment size	Core drill diameter, mm
64003BBH (BS; BSH)	24 x 3,5 x 11	D62 – 72
64004BBH (BS; BSH)	24 x 3,5 x 11	D77 – 92
64005BBH (BS; BSH)	24 x 3,5 x 11	D102 – 127
64006BBH (BS; BSH)	24 x 4 x 11	D132 – 152
64007BBH (BS; BSH)	24 x 4 x 11	D162 – 182
64008BBH (BS; BSH)	24 x 4,5 x 11	D200 – 275
64009BBH (BS; BSH)	20 x 5 x 11	D300 – 600

## 12. Diamond segments for core drills

### Rooftop diamond segments

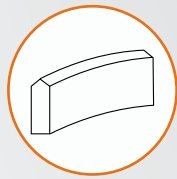

#### APPLICATION

- Drilling of reinforced concrete;



- drilling machines with medium capacity.

Catalog number	Segment size	Core drill diameter, mm
64011ABH (BS; BSH)	24 x 3,5 x 11	D62 – 72
64012ABH (BS; BSH)	24 x 3,5 x 11	D77 – 92
64013ABH (BS; BSH)	24 x 3,5 x 11	D102 – 127
64014ABH (BS; BSH)	24 x 4 x 11	D132 – 152
64015ABH (BS; BSH)	24 x 4 x 11	D162 – 182
64016ABH (BS; BSH)	24 x 4,5 x 11	D200 – 275
64019ABH (BS; BSH)	20 x 5 x 11	D300 – 600

## 13. Diamond core drills for manual electric drills



#### APPLICATION

- Drilling of bricks, reinforced concrete and other materials.



- No coolant required.

Catalog number	Core drill diameter, mm	Type of assembly
<b>Without shank</b>		
73068BBS	68	M16
73072BBS	72	M16
73082BBS	82	M16
<b>With shank</b>		
73168BBS	68	SDS plus
73172BBS	72	SDS plus
73182BBS	82	SDS plus

## Core styles of diamond segmented blades

Blades can be produced with different types of gullets depending on equipment and the processed material.

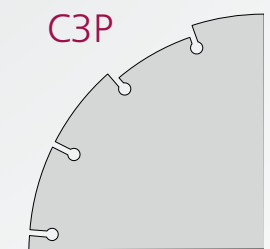
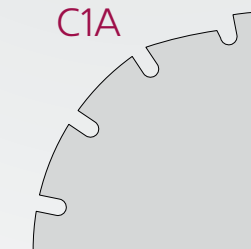
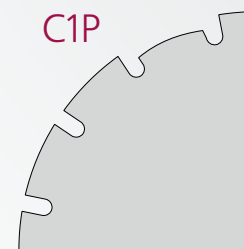
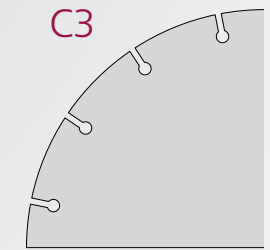
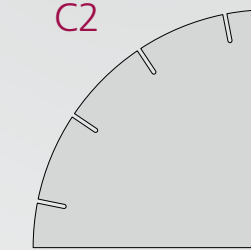
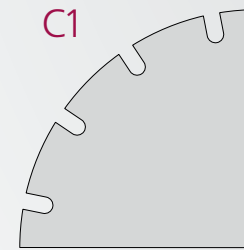

## Types of arbor holes

F4

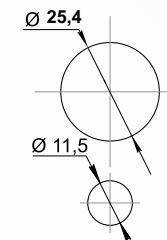

F5

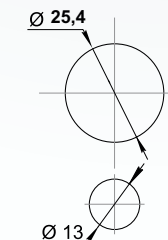

F6

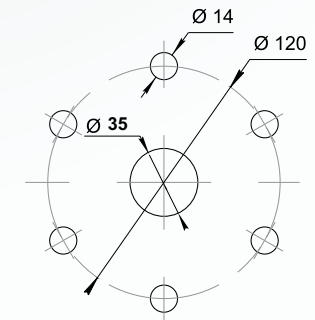

F10

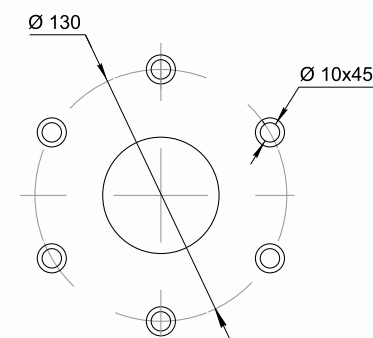

F15

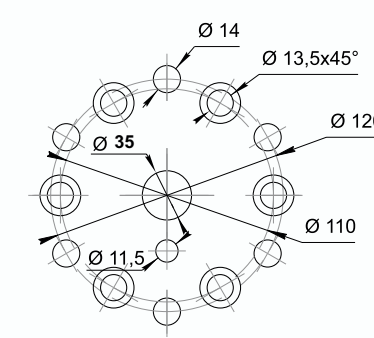

F17

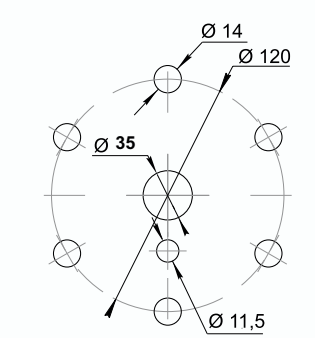



PrJSC "POLTAVA DIAMOND TOOLS"

 [pdtools.com.ua](http://pdtools.com.ua)



EN 13236 